

Silent Icon

In this new urban tissue of Downtown Beirut the House of Art & Culture: DARBAYRUT' will be a 'Silent Icon'. Providing a 'neutral space', the building generates a poetic background, without imposing itself on the artists and easy to use.

Globalization and Cultural representation

Globalization and national identity are generally considered as opposed conditions. The present situation is seen as the result of a development which started with the weakening of the nation-state, and resulted in an unbounded world. The changes can be described in terms of a new perception of space: the nation-state with its strictly controlled borders has been transcended by a new world of almost unlimited networks. The flows of information, economy, transport, culture or tourism create a global environment with consequences for human consciousness.

Landscape

The formative elements of the 'House of Art & Culture: DARBAYRUT' are its hanging gardens. They wrap a 'second skin' around the compact building comprising of a vertical garden. This project formulates an eradicative metamorphosis from the classic 'hortus seclusius' - the secret garden - into contemporary hanging gardens. The traditional arabic landscapes and walled garden are inversed from inside out to protectively wrap the building and its habitants against everyday hassle.

8000CU

Botanical Garden Façade

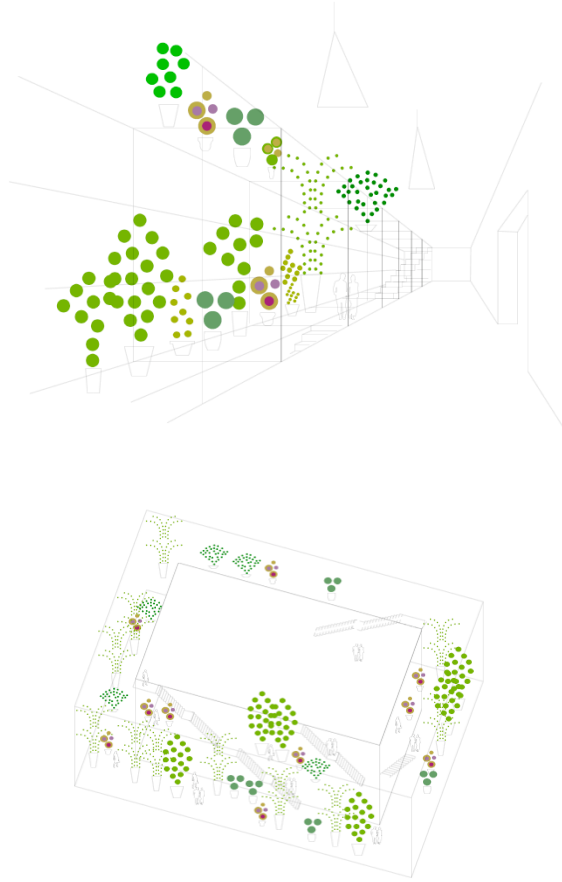

'House of Art & Culture: DARBAYRUT' will be an invitation to look beyond 'familiar boundaries' at the varieties of cultures. Creating a space between art and locality. Workshops, Classrooms and all focus the habitants and visitors view internally. The gaze out of the window always turns out into the vertical garden, which consists of numerous groves of which several are known to exist more than a thousand years. One cannot see the neighbouring buildings nor the street. The outer skin is translucent. The space between outer and inner skin contains groves and displaces them to the visitor like being in a botanical garden. They relate, represent and connect the Arabic world growing in different climates. Some have contributed to major human advancement or development, in terms of proving crop or building material, as well as for spiritual and cultural activities. These groves grow all over the Mediterranean region: from Africa, Arabia, India ort he Far east. Within the respective Region, they symbolize different aspects, which leave many traces not only in the Arabic world. This proposal selects of 10 plants: Myrtle, Orange, Aleppo, Myrrh, Olibanum Tree,, Olive Tree,, Date Palm, Pine, Lebanon Cedar. Lemon, Pomegranat

8000CU

Ecological building technology

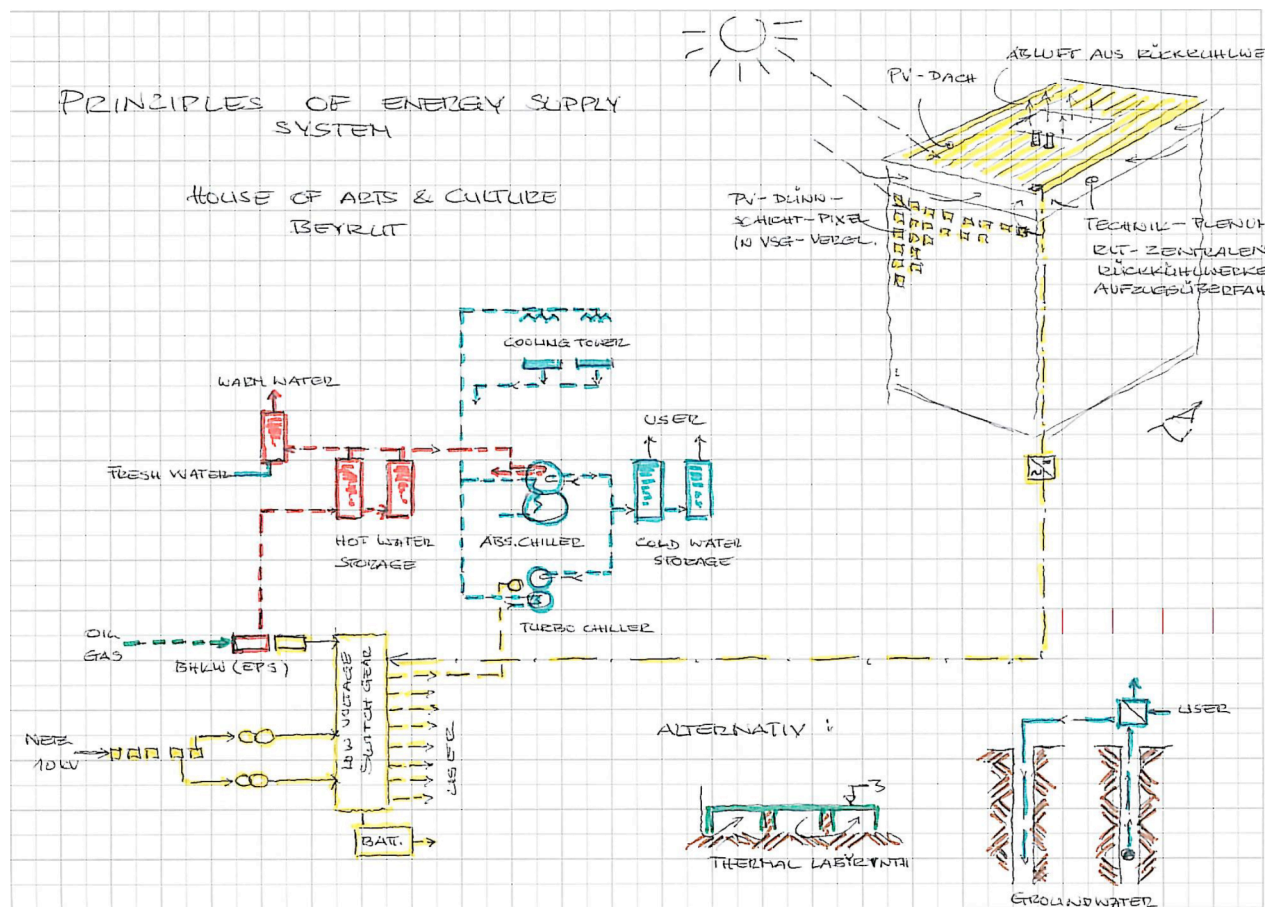

The compact shape naturally helps reducing heat gain in warm periods and greater heat loss in colder times. To reduce energy consumption the interest of this design is to use all natural resources as efficiently as possible. In addition to wearing a 'green coat', which provides shadow and act as a buffer zone, it enhances the micro-climate. In that sense the application of a thermo labyrinth (2 meter low under the building) or the use of groundwater for a pre-cooling system shall be further investigated.

8000CU

Building structure

The structure consists of flat ceilings and supporting pillars or walls. On the ceiling of the Small and the Great Hall horizontally carrying elements are assembled. Those elements are below the ceiling in the Small Hall, their length is about 16 metres. In the Great Hall, they are one storey high and about 24 metres long. Furthermore, they are built with breakthroughs over the Great Hall - so-called Virendeel carriers are created. Vertical loads of pillars and walls are led to the soil through locally reinforced foundations. Walls and ceilings are stabilizing elements against the load cases "wind" and "earthquake".

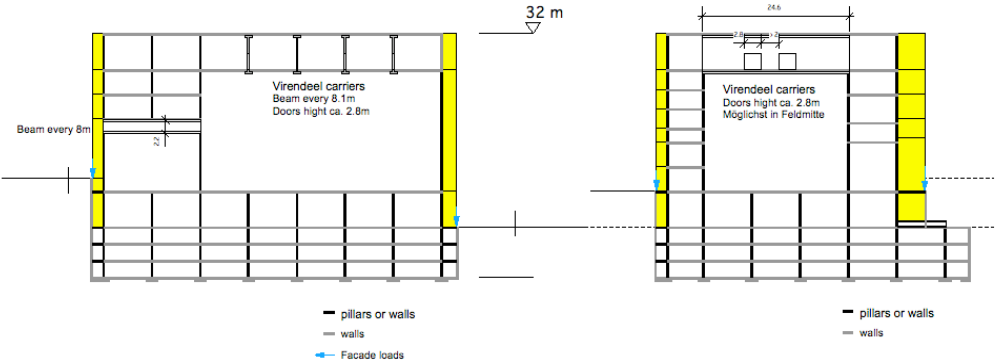

8000CU