

## THE HOUSE OF ARTS & CULTURE

The Lebanese-Omani Centre

The project was developed from the study of three topics: the urban context, the local culture, and the needs of the architectural program.

These topics are supplemented with environmental solutions, technology and experiences that make a building that dialogue to its surroundings and surprise anyone to visit it.

The context show us an arid environment where dominate the surrounding constructions which together give the appearance of a dry desert where most of its pieces are with similar characteristics.

To planning the architectural design we decided to give it the appearance of an "oasis" to balance the dryness that can be seen in the area providing a core of vegetation that is integrated with a neutral and simple volumetry that respects the context.

The architecture of the building is a complicated intersection of volumes, terraces and objects that are intertwined as functional as possible, this approach makes a volumetry of several shapes and proportions that are captured with sandy textures that are wrapped by a leather cube that integrates the vegetation, this is an analogy between the project and the Lebanese culture where diversity, integration and harmony are the most representative traits of Beirut.

The green skin that wraps the project is generated to separate the exterior-interior transitions where vegetation accompanies visitors on their tour through each of the spaces in the project. This green skin protects the spaces from the effects of sun and thermal insulator function by reducing the consumption of cooling systems.

The roof is tilted 20° towards the south. This cover is a network of solar panels and green pixels.

# 1982TL

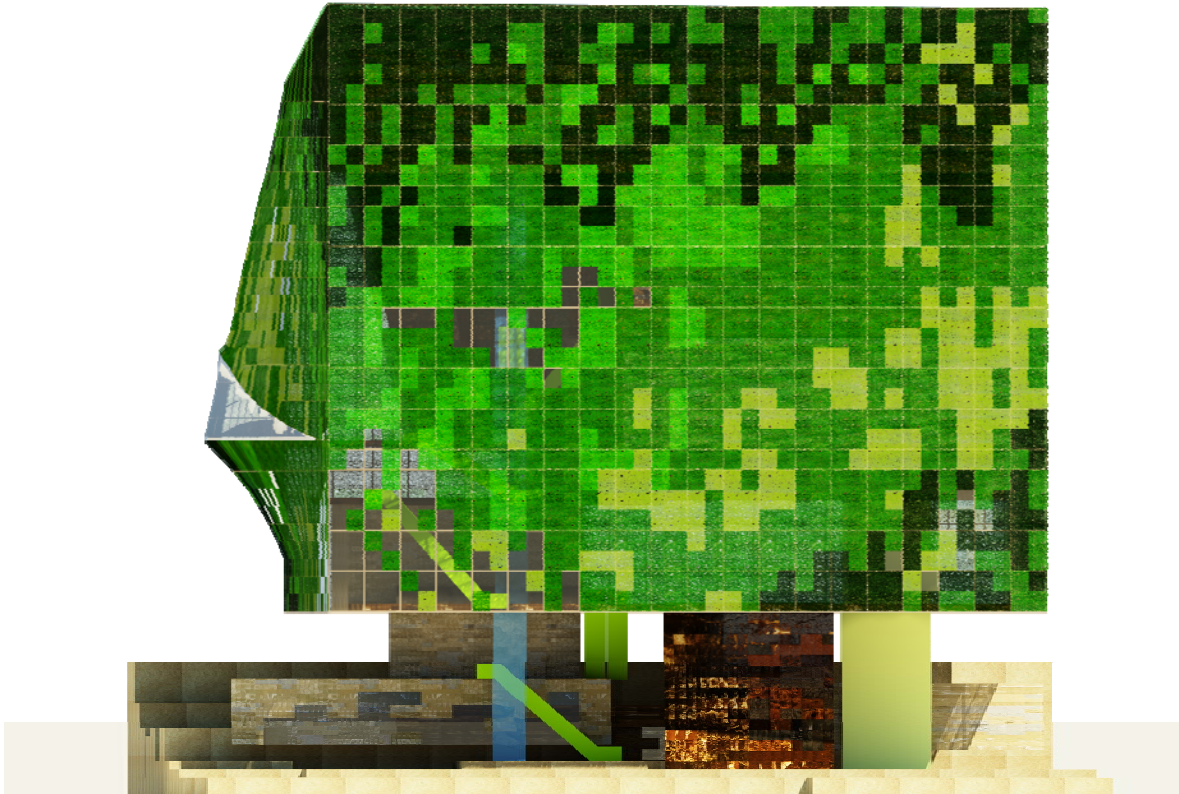

The building starts from a square-modulated and divided by the terraced roofs of the administrative areas, cafeteria and services, this proposal aims to develop temporary exhibitions open to the public and a pedestrian walkway across the ground from one extreme to another in an open plan to stimulate the interest of citizens in the art, this space is designed as a meeting place where people can develop exhibitions, events, small shows and all kinds of activities related to culture and art.

In this same square is the coffee-shop that can operate autonomously to the complex. The administrative area and services are the places from level -1 and -2 forming the movement of volumes and terraces of the square.

# 1982TL

Pedestrian access to the square is opened around the perimeter of the field and on the north side is the main entrance to the complex. In this side is the vehicular access and services through a ramp that descends to the basement parking (3 levels).

The first level is a place to exhibit and is integrated with the public plaza at the lower level, this is an open plan where you can develop all kinds of events and exhibitions.

At this level is a vestibule that leads us to the main foyer from which we can enter the Performance and Conference Hall.

The Foyer is a very important piece of the project because it is an element that links to a large part of the spaces, this is developed on 3 levels and makes an amplitude and movement perspectives.

In the foyer is an overhang that goes through the vegetation skin forming a fold on the facade that breaks the visual of the architectural object.

The Large Performance and Conference Hall was designed as a neutral object, smart and versatile object to make any kind of interpretations, one of the challenges of the Performance Hall was to develop a mechanical system that rotates stage and the first module of seats keeping the acoustic and isolation.

The cinema is located on the same level of the Performance Hall; up this object is the Cinematheque and the Documentation Centre. In the last level are the Workshops and the Trainingrooms.

The complex consists of a series of positions that are stacked one after another to contain the required program, the structure of this set is formed by vertical elements of concrete, the vegetation skin is surrounding by reticular steel structure to give rigidity and balance to the heart of the complex internal structure.

# 1982TL

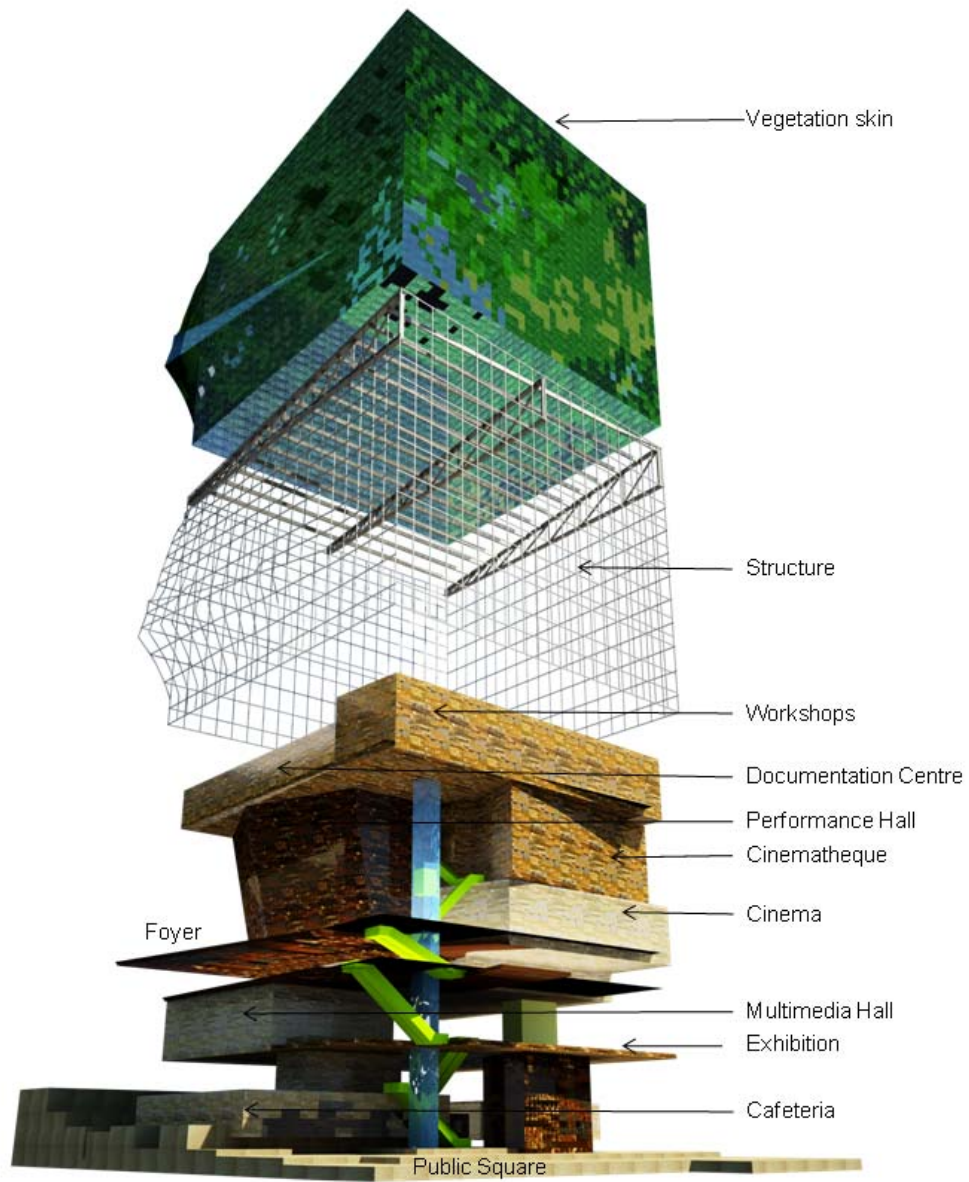

**1982TL**